

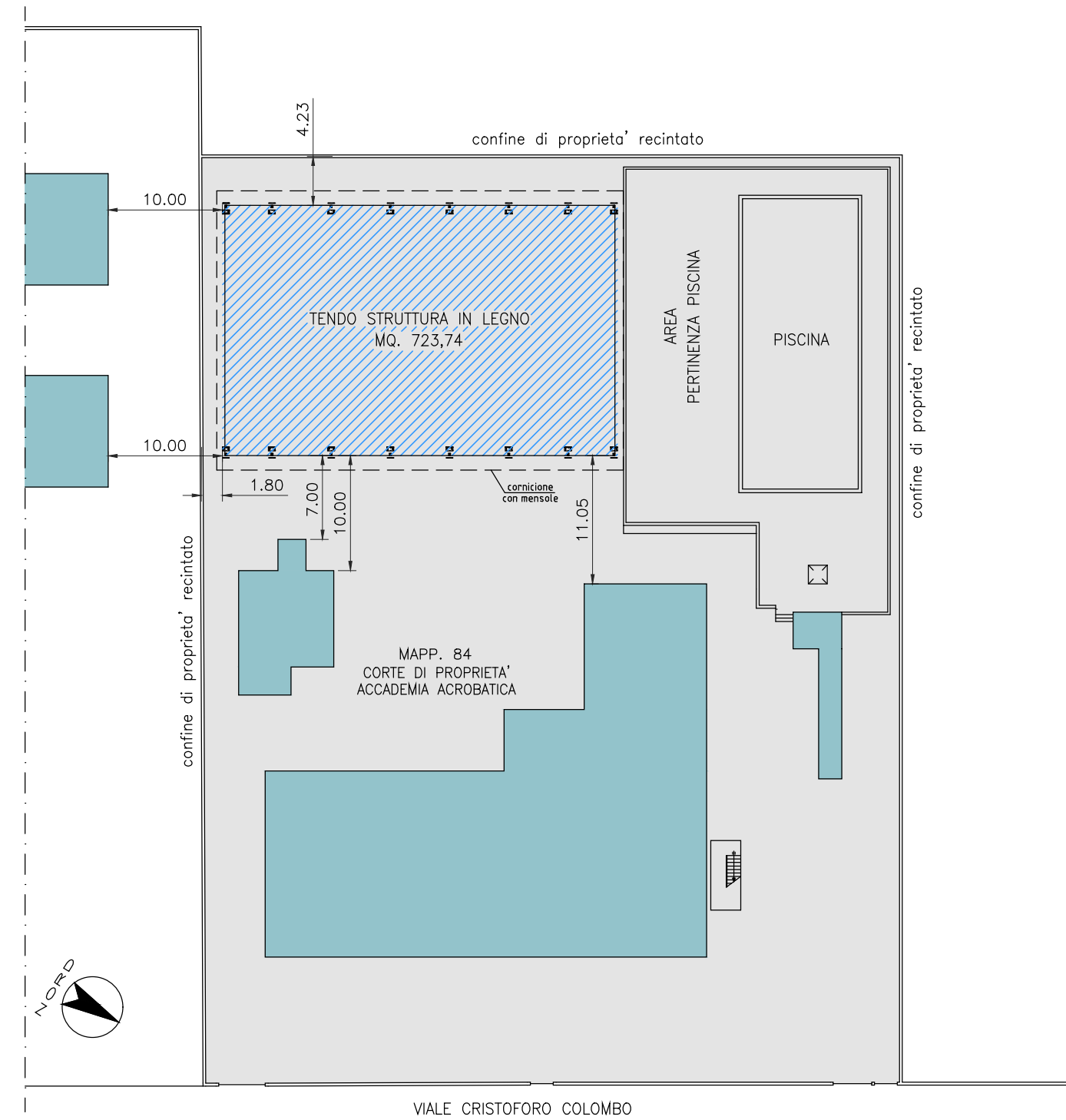

DATI TECNICI COLONIA "A"	
I dati relativi alla superficie coperta e al volume si riferiscono alla struttura adibita a palestra.	
AREA LOTTO	mq. 4.480,00
SCO (superficie coperta) "A"	mq. 723,74
VT (volume totale) "A"	mc. 5.016,81

DATI TECNICI COLONIA "B"	
I dati relativi alla superficie coperta e al volume si riferiscono alle strutture adibite a palestre.	
AREA LOTTO	mq. 18.634,00
SCO (superficie coperta) "B1"	mq. 1.258,25
VT (volume totale) "B1"	mc. 7.385,66
SCO (superficie coperta) "B2"	mq. 1.213,80
VT (volume totale) "B2"	mc. 5.728,80
SCO (totale)	mq. 2.472,05
VT (volume totale)	mc. 13.114,46

PLANIMETRIA scala 1:500



 STRUTTURA SPORTIVA
IN COSTRUZIONE

 EDIFICI NON OGGETTO
DI INTERVENTO

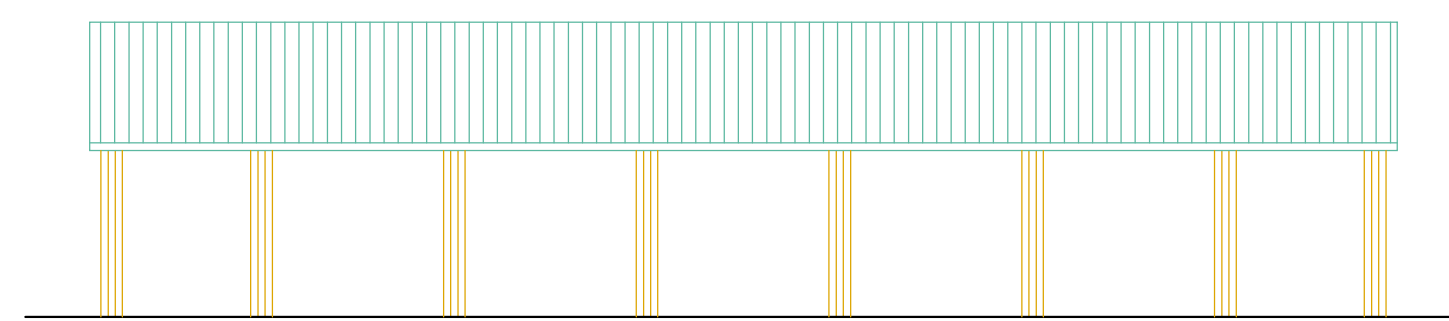

PROSPETTO NORD - EST

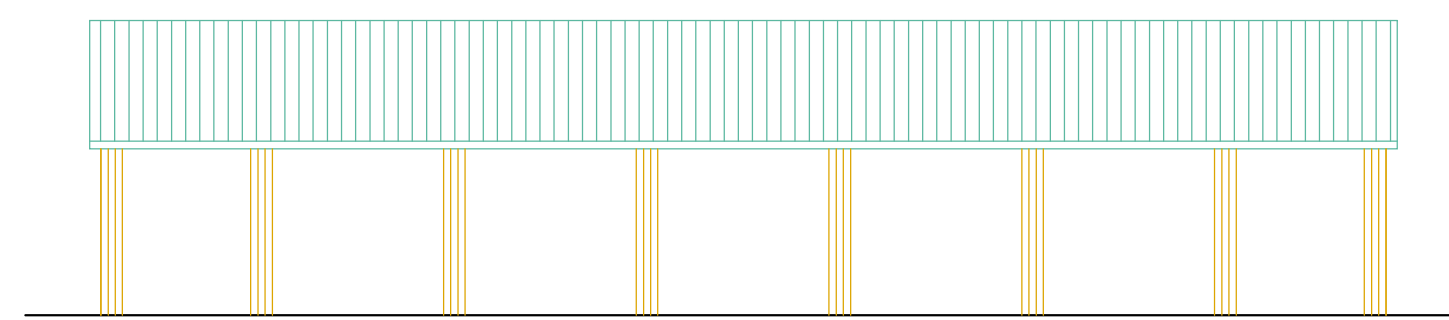

PROSPETTO SUD - OVEST

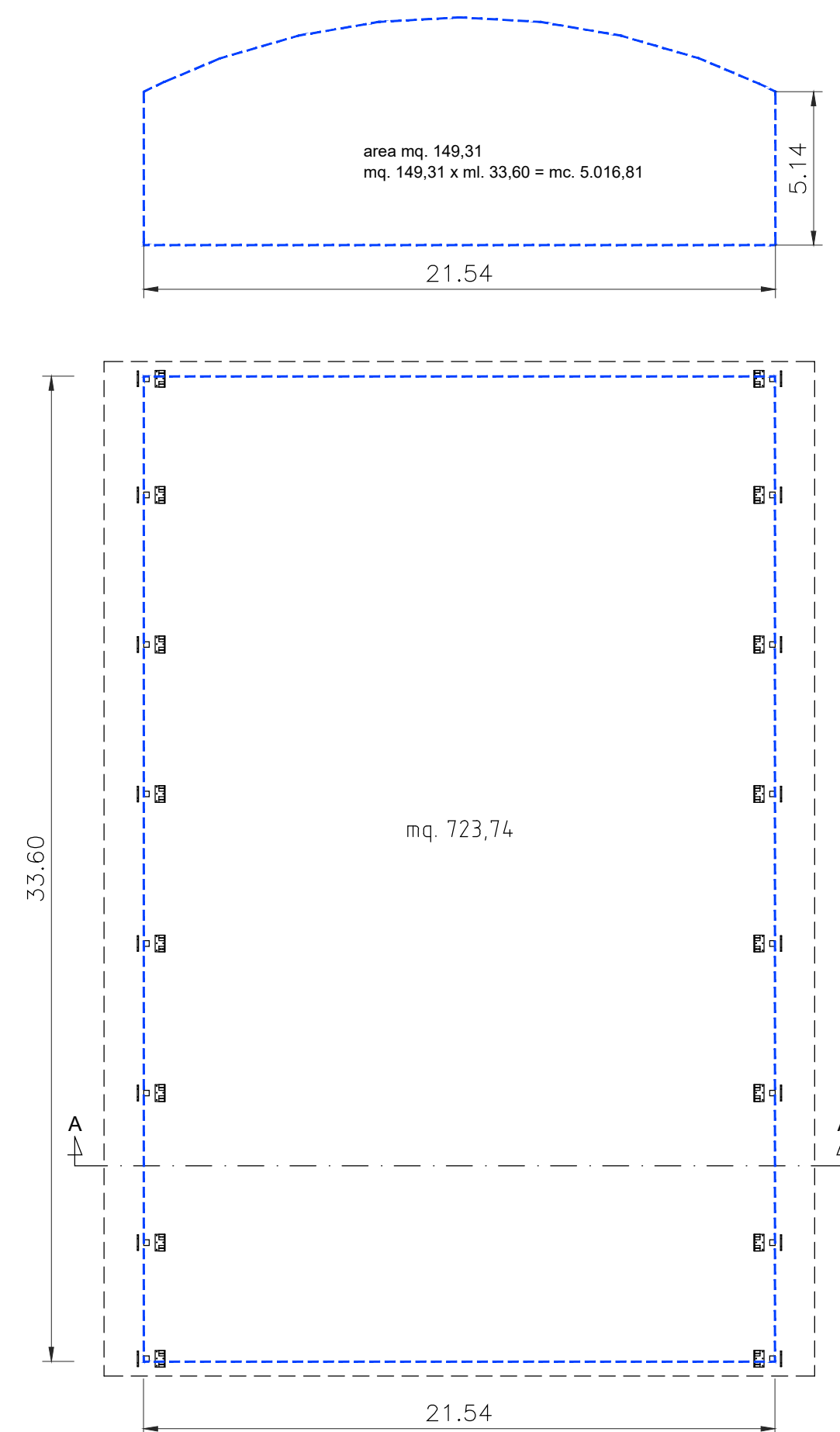

PIANTA 1:200

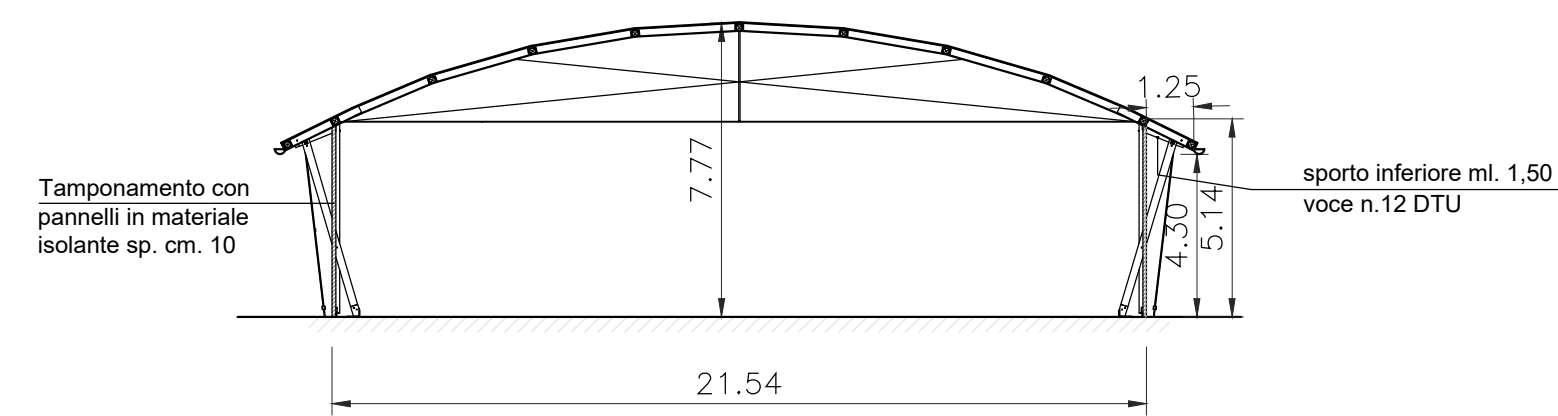

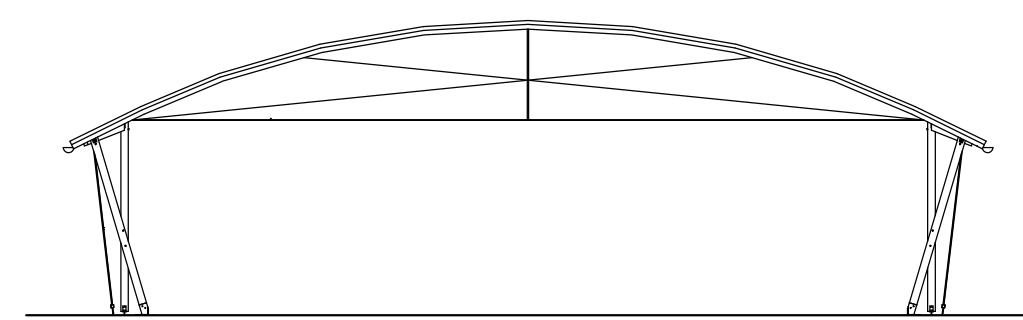

SEZIONE A - A' 1:200

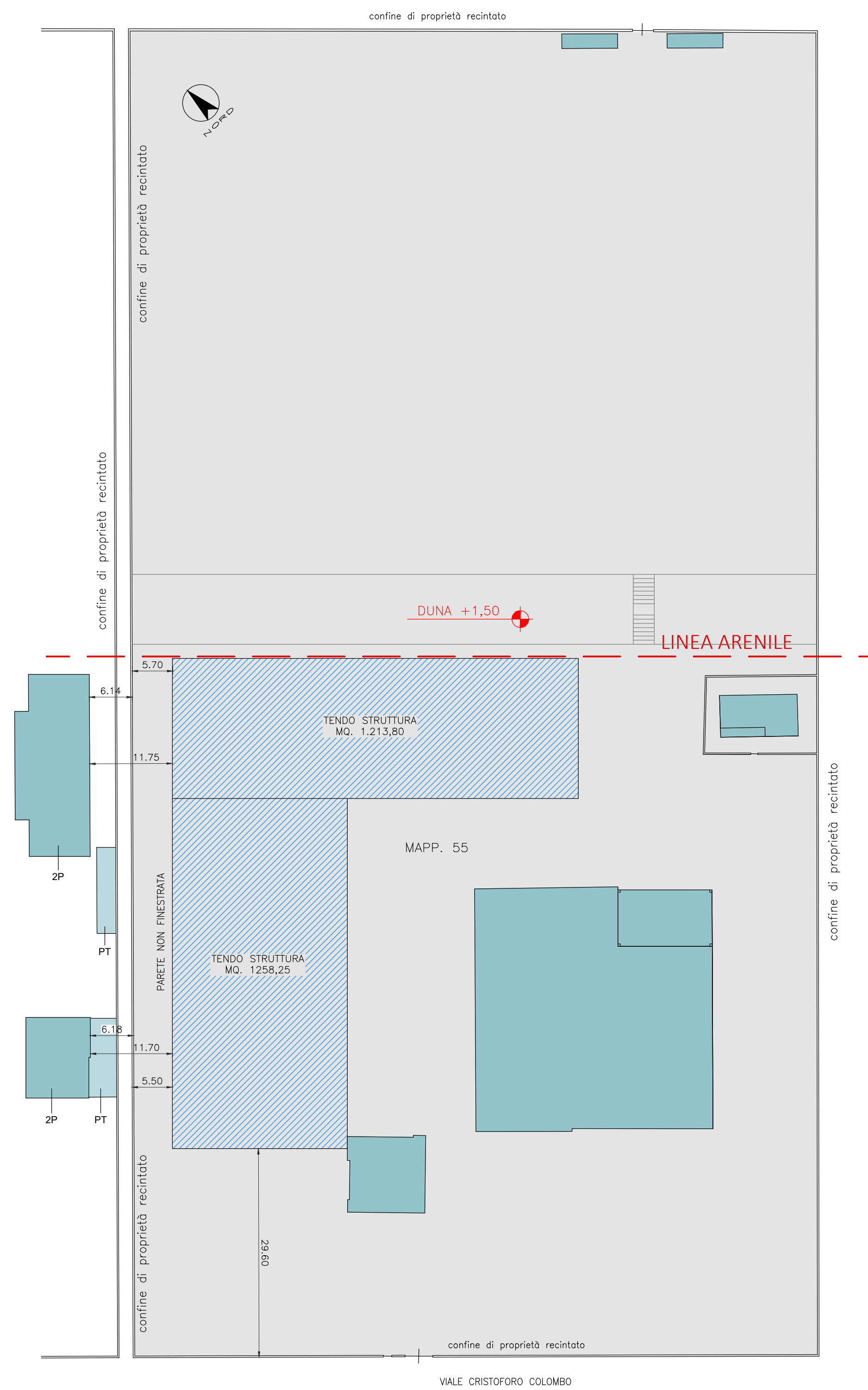

PROSPETTO NORD - OVEST

PLANIMETRIA scala 1:500



 STRUTTURA SPORTIVA
IN COSTRUZIONE

 EDIFICI NON OGGETTO
DI INTERVENTO

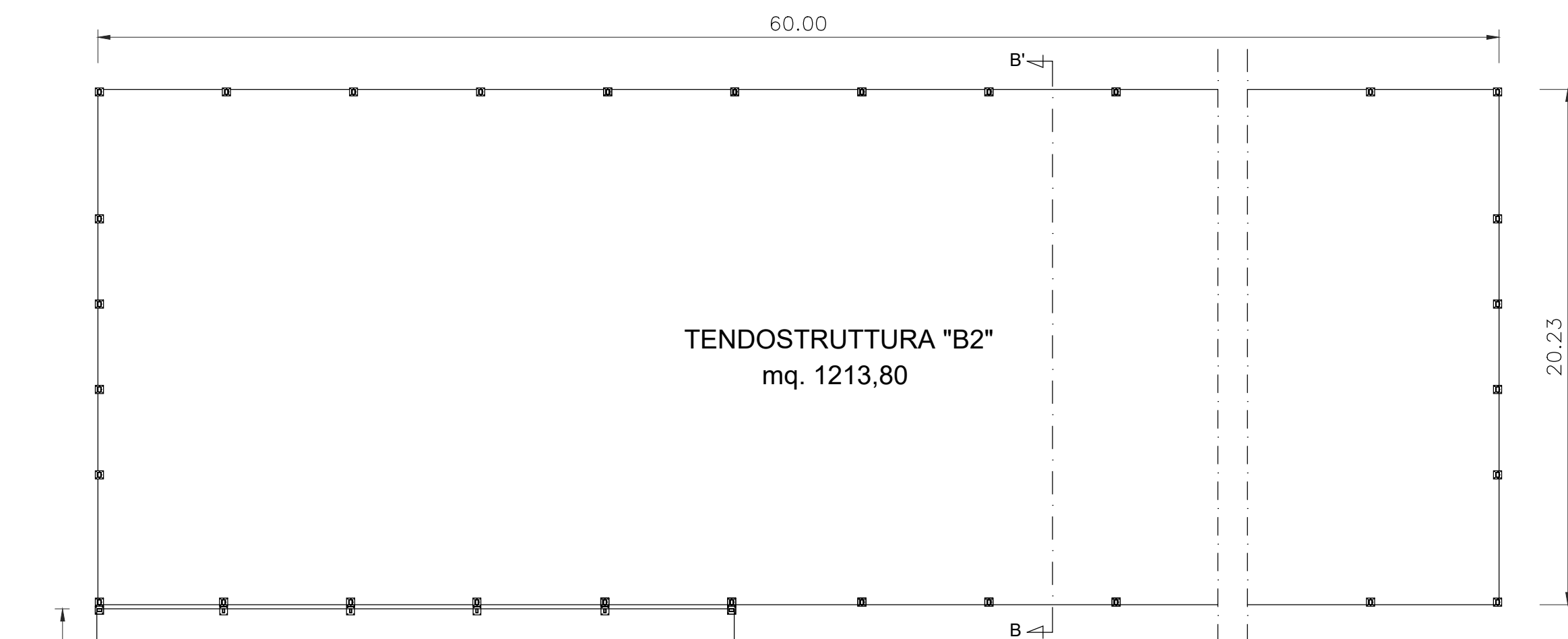

TENDOSTRUTTURA "B1"
mq. 1258,25

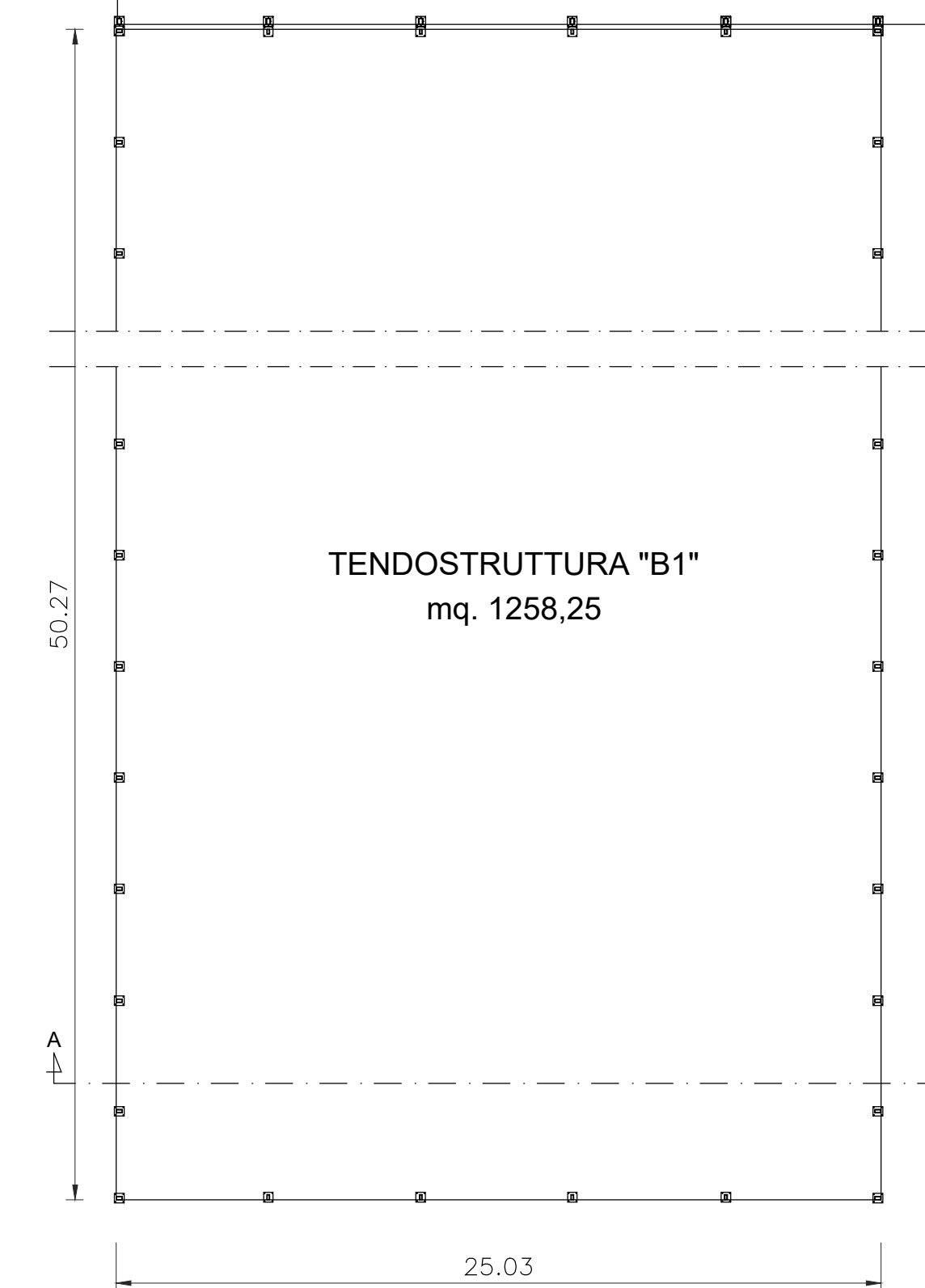

PIANTA scala 1:200

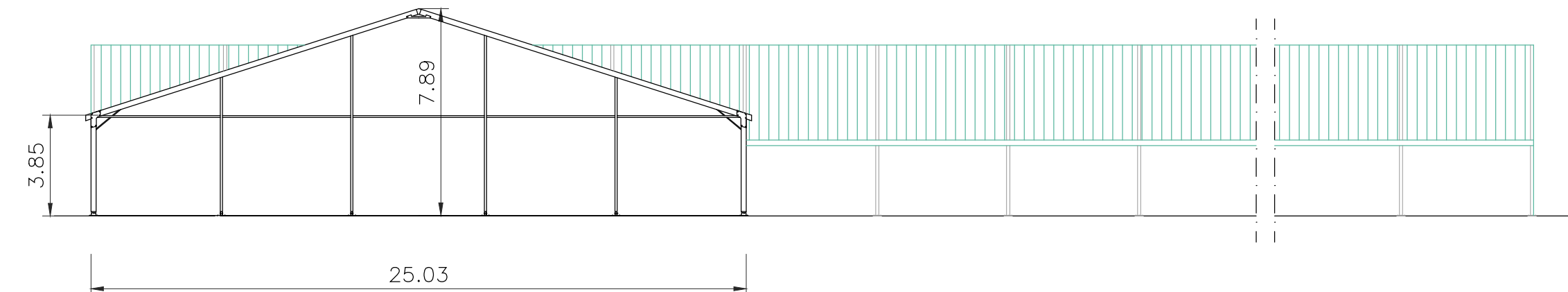

SEZIONE A - A ' scala 1:200

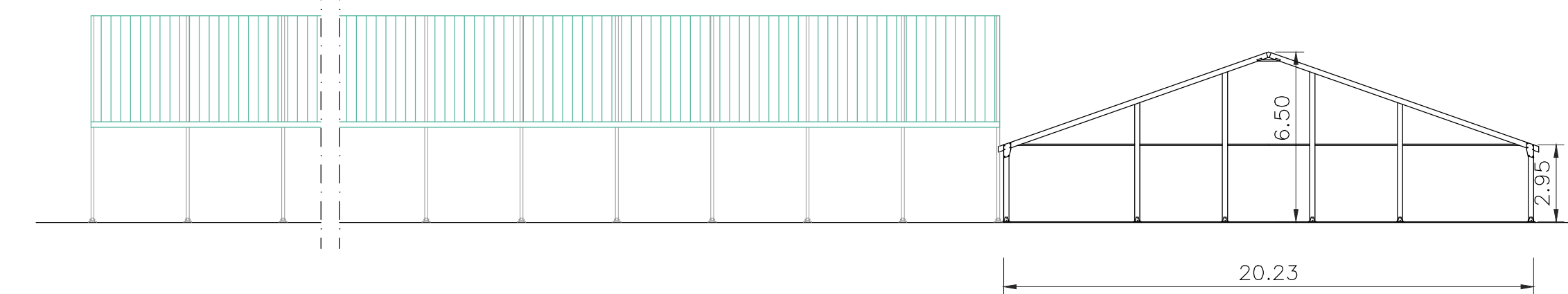

SEZIONE B - B' scala 1:200